

REF. NO: MPCL 95CAT PG 72

REVISION

C.O.N	SYM	DESCRIPTION	DATE	DRAWN	APPR'D
	A	(1) ADDED	11/18/02	T.TSUGAWA	

GENERAL:

MODEL LP-50FB IS A 50 mm STROKE CONDUCTIVE PLASTIC, LINEAR MOTION POTENTIOMETER WITH A RETURN SPRING. ITS UNIQUE DESIGN, PRECISION CONSTRUCTION AND COMOLD ELEMENT ALLOW THE UNIT TO FEATURE SUPERB SMOOTHNESS AND LONG LIFE.

ELECTRICAL SPECIFICATIONS:

ELECTRICAL STROKE:	50 mm (F.S.)
TOTAL RESISTANCE:	0.2, 0.5, 1, 2, 5 KOHMS
TOTAL RESIS. TOLERANCE:	±20%
LINEARITY (INDEPENDENT):	±0.5% (±0.2% AVAILABLE)
REPEATABILITY:	±0.005%
POWER RATING:	1.5 WATTS @70°C
INSULATION RESISTANCE:	500 meg OHMS MIN. @ 500 Vdc
DIELECTRIC STRENGTH:	500 Vrms, 50/60Hz, for 1 MINUTE
RESISTANCE TEMP. COEFFICIENT:	400 ppm/°C

MECHANICAL SPECIFICATIONS:

MECHANICAL STROKE:	55 mm
FRICTION (SPRING FORCE):	170 gf (6 oz)
WEIGHT:	75 g (2.7 oz)

ENVIRONMENTAL SPECIFICATIONS:

OPERATING TEMPERATURE:	-40°C to +100°C
VIBRATION:	10 Gs, 500 Hz
SHOCK:	50 Gs, 11 ms
LIFE:	5 MILLION CYCLES MIN.

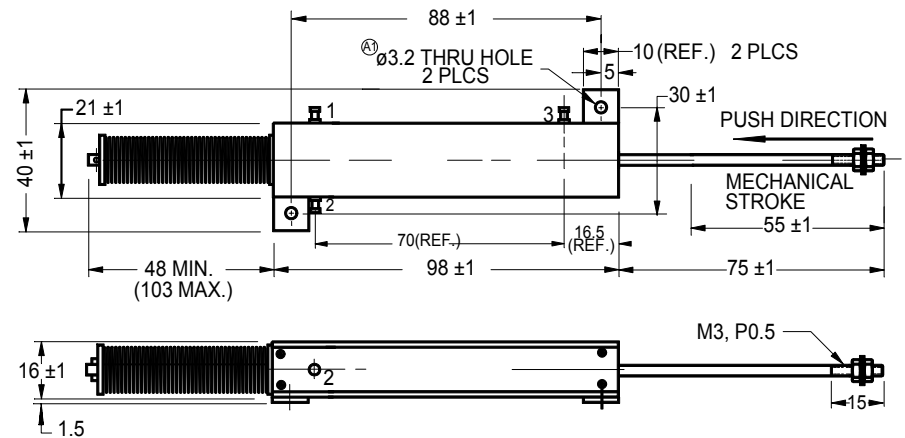

FIGURE 1 OUTLINE DIMENSIONS

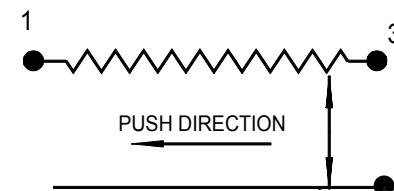

FIGURE 2 SCHEMATIC



GUEMISA

Sta. Virgilia 3-b ; 1°F 28033 Madrid
 Tfno.: 91 764 21 00 Fax.: 91 764 21 32
 Email: info@guemisa.com

UNLESS OTHERWISE SPECIFIED, DIMENSIONS ARE IN mm(in).

TOLERANCES:
 ANGLES ±1.5°
 ≤10 mm: ±0.25
 <100 mm: ±0.5
 ≥100 mm: ±1

DRAWN	T.TSUGAWA	DATE	4/7/97
CHECKED		DATE	
APPROVED		DATE	
APPROVED		DATE	
SCALE:			

SPECIFICATION DWG
 FOR
MODEL LP-50FB
 LINEAR MOTION
 POTENTIOMETER
 (WITH RETURN SPRING)

A-MAC-C02	A
1 OF 1	