

10739

REFERENCE: MPLC 92 CATALOG P.74

REVISION

C.O.N	SYM	DESCRIPTION	DATE	DRAWN	APPR'D
	D	1) TOLERANCE FOR MECHANICAL STROKE WAS ±1 mm.	02/02/03	T.TSUGAWA	

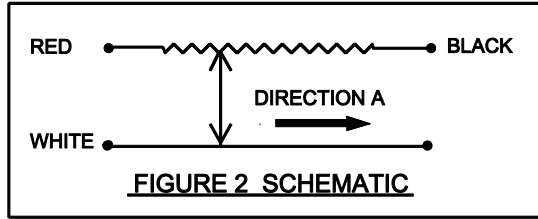

**GUEMISA**  
 Sta. Virgilia 3-b ; 1ºF 28033 Madrid  
 Tfno.: 91 764 21 00 Fax.: 91 764 21 32  
 Email: info@guemisa.com

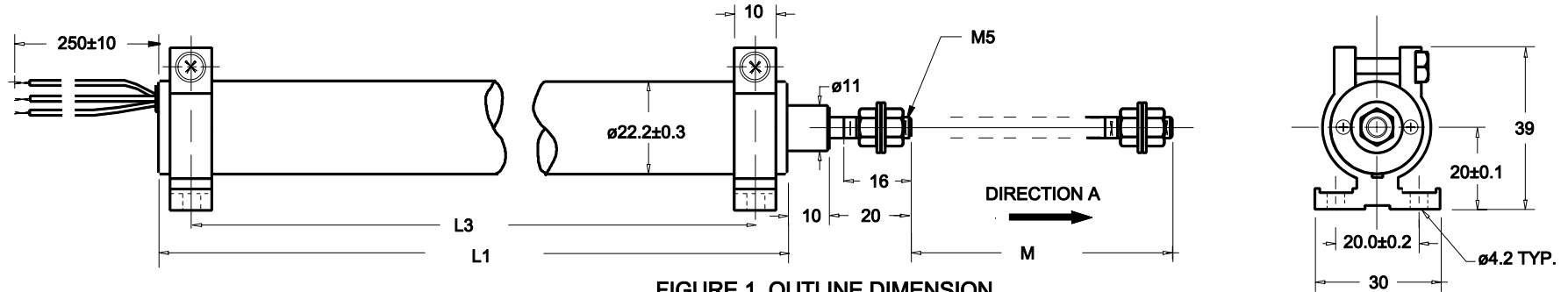

FIGURE 1 OUTLINE DIMENSION

**SPECIFICATIONS**

MODEL NO.:	<sup>B1</sup> LP-50F-61	LP-100F	LP-150F	LP-200F	LP-250F	LP-300F	LP-400F
ELECTRICAL STROKE :	50 mm	100 mm	150 mm	200 mm	250 mm	300 mm	400 mm
MECH. STROKE ( M ) : <sup>D1</sup>	53 ±2 mm	103 ±2 mm	153 ±2 mm	203 ±2 mm	253 ±2 mm	303 ±2 mm	403 ±2 mm
RESISTANCE in KOHMS (±20%) :	0.5, 1, 2, 5	0.5, 1, 2, 5, 10	1, 2, 5, 10	1, 2, 5, 10, 20	2, 5, 10, 20, 30	2, 5, 10, 20, 30	5, 10
POWER RATING :	1.5 W @ 70°C	2.5 W @ 70°C	3 W @ 70°C	4 W @ 70°C	4 W @ 70°C	4 W @ 70°C	4.5 W @ 70°C
HOUSING LENGTH ( L1 ) :	88±1 mm	138±1 mm	188±1 mm	238±1 mm	288±1 mm	338±1 mm	438±1 mm
MTG HOLES SPACING ( L3 ) :	74±1 mm	124±1 mm	174±1 mm	224±1 mm	274±1 mm	324±1 mm	424±1 mm
<sup>A2</sup> INDEPENDENT LINEARITY:	±0.5% (±0.2% AVAILABLE)	±0.3% (±0.1% AVAILABLE)	±0.3% (±0.1% AVAILABLE)	±0.3% (±0.1% AVAILABLE)	±0.3% (±0.1% AVAILABLE)	±0.3% (±0.1% AVAILABLE)	±0.1%
OUTPUT SMOOTHNESS:	0.1% MAX.						
INSULATION RESISTANCE:	100 meg OHMS MIN. @ 500 Vdc						
DIELECTRIC STRENGTH:	<sup>C1</sup> 500 Vrms @ 50/60 Hz for 1 MINUTE						
OPERATING TEMPERATURE:	-40°C to +125°C						
TEMPERATURE COEFFICIENT:	±400 ppm/°C MAX.						
FRICTION:	100 g MAX.						

UNLESS OTHERWISE SPECIFIED, DIMENSIONS ARE IN mm(in).  TOLERANCES: ANGLES: ±1.5° <10 mm: ±0.25 <100 mm: ±0.5 >100 mm: ±1	DRAWN	DATE	SPECIFICATION DWG FOR MODEL LP-xxxF LINEAR POTENTIOMETER	Midori America Corporation FULLERTON, CA
	T. TSUGAWA	11/19/92		
	CHECKED	DATE		
	APPROVED	DATE		
	APPROVED	DATE		
SCALE:			FILE: LP-xxxF	A-MAC-B35 D
				1 OF 1